



American Power Design, Inc.

"The best high voltage design solution"

H10 SERIES 10 WATT HIGH VOLTAGE DC/DC CONVERTERS



FEATURES

- * Customer Selects Output Voltages
- * Wide Input Ranges
(5-15 Vdc , 9-36 Vdc , 20-60 Vdc)
- * Efficiency 83% (typ.)
- * Independently Isolated Outputs
- * Six-Sided Shield Case
- * Remote On/Off Control
- * 100 kHz Switching Frequency

The H10 Series of DC/DC converters accepts ultra wide input ranges of 5-15 Vdc, 9-36 Vdc, & 20-60 Vdc. Outputs are independently isolated. In the case of duals, full power may be taken from either output. All models will tolerate a short circuit indefinitely. Also included is a Pi input filter and remote on/off.

ELECTRICAL SPECIFICATIONS

Voltage Accuracy	+/- 3%	Short Circuit Protection	Input Current Foldback
Input Regulation.....	+/-3%	Input Filter	Pi Network
Load Regulation	(20% to full load) +/-3%	Efficiency	83% (typ.)
Output Ripple.....	+/-0.3%	Switching Frequency	100 kHz
		Isolation (Input-Output(1)-Output(2)-Case).....	1Kv

* 9-36 Vdc Input add suffix /A
* 20-60 Vdc Input add suffix /B

GENERAL SPECIFICATIONS

Temp. Stability.....	+/- 0.02%/°C	Logic Shutdown.....	Logic 0 (on)
Temp. (Operating,Case)	-45 to +85°C	EMI/RFI	Six-Sided Shield
Temp. (Storage)	-55 to +100°C	Temp. Derating	None
		Cooling	Free-Air Convection

* All models designed to meet UL 60950
* For RoHS Compliant part, add suffix /Y

PHYSICAL SPECIFICATIONS

Dimensions	2.0 x 2.0 x 0.5 inches	Case Material	Nickel Plated Copper
Weight	2.8 Oz		(With Non-Conductive Base Plate)



American Power Design, Inc.

"The best high voltage design solution"

H10 SERIES 10 WATT HIGH VOLTAGE DC/DC CONVERTERS

REPRESENTATIVE MODEL LISTING						
MODEL NUMBER	INPUT SPECIFICATIONS		OUTPUT SPECIFICATIONS			
	VOLTAGE	CURRENT	OUTPUT #1		OUTPUT #2	
			VOLTAGE	CURRENT	VOLTAGE	CURRENT
H10-50	5V - 15V	2.4A - .8A	50V	200ma	-	-
H10-50/50	5V - 15V	2.4A - .8A	50V	100ma	50v	100ma
H10-75	5V - 15V	2.4A - .8A	75V	133ma	-	-
H10-75/75	5V - 15V	2.4A - .8A	75V	66ma	75v	66ma
H10-100	5V - 15V	2.4A - .8A	100V	100ma	-	-
H10-100/100	5V - 15V	2.4A - .8A	100V	50ma	100v	50ma
H10-150	5V - 15V	2.4A - .8A	150V	66ma	-	-
H10-150/150	5V - 15V	2.4A - .8A	150V	33ma	150v	33ma
H10-200	5V - 15V	2.4A - .8A	200V	50ma	-	-
H10-200/200	5V - 15V	2.4A - .8A	200V	25ma	200v	25ma
H10-300	5V - 15V	2.4A - .8A	300V	33ma	-	-
H10-300/300	5V - 15V	2.4A - .8A	300V	16ma	300v	16ma
H10-400	5V - 15V	2.4A - .8A	400V	25ma	-	-
H10-400/400	5V - 15V	2.4A - .8A	400V	12ma	400v	12ma
H10-500	5V - 15V	2.4A - .8A	500V	20ma	-	-
H10-500/500	5V - 15V	2.4A - .8A	500V	10ma	500v	10ma

* 9-36 Vdc input add suffix /A

* 20-60 Vdc input add suffix /B

* RoHS Compliant add suffix /Y

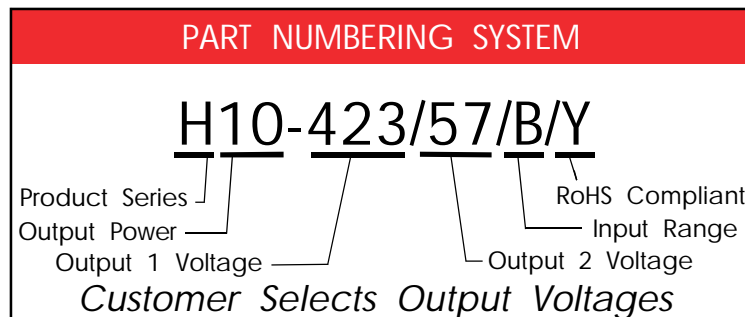



American Power Design, Inc.

"The best high voltage design solution"

H10 SERIES 10 WATT HIGH VOLTAGE DC/DC CONVERTERS

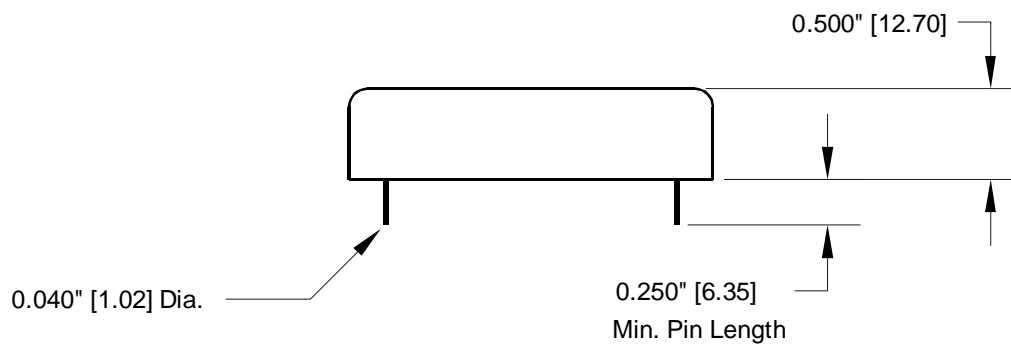
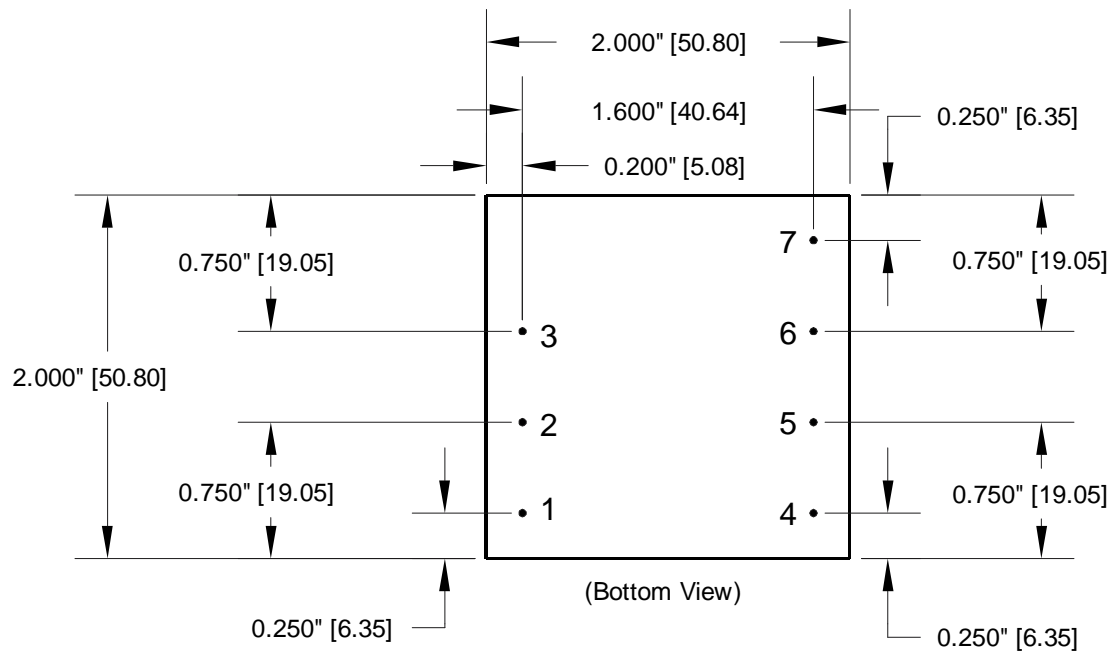

Pin #	Single	Dual
1	- INPUT	- INPUT
2	On/Off	On/Off
3	+ INPUT	+ INPUT
4	No Pin	OUTPUT 2 +
5	No Pin	OUTPUT 2 -
6	OUTPUT 1 -	OUTPUT 1 -
7	OUTPUT 1 +	OUTPUT 1 +

*Dimensions are in Inches
[Metric equivalents in brackets]*